

LETTER	INCHES [MILLIMETERS]	
	MINIMUM	MAXIMUM
A	.1783 [4.53]	.1807 [4.59]
B	.1374 [3.49]	.1383 [3.51]
C	.0354 [0.90]	.0366 [0.93]
D	.060 [1.52]	.070 [1.78]
E	.092 [2.34]	.096 [2.44]

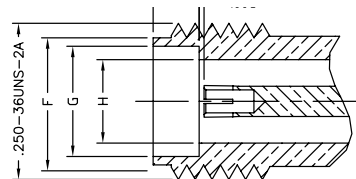

LETTER	INCHES [MILLIMETERS]	
	MINIMUM	MAXIMUM
F	.208 [5.28]	.212 [5.38]
G	.181 [4.60]	.183 [4.65]
H	.1374 [3.49]	.1382 [3.51]
I	.075 [1.91]	.077 [1.96]

## SPECIFICATIONS

### PLATING

G- Gold  
SS - Stainless Steel

### DIELECTRIC

R - Rexolite®

### GENERAL SPECIFICATIONS

**MATERIALS:** **Body:** Stainless Steel, Corrosion-Resistant, Non-Magnetic 303, Per ASTM A484 and A582. **Contacts:** Beryllium Copper, QQ-C 530, Alloy 173. **Dielectric:** Rexolite®

**FINISH:** **Center Contacts** are gold plated per MIL-G- 45204 Type II, Class 1 over Nickel plate per QQ-N-290. **Body** and Body components are passivated per ASTM A380.

### MECHANICAL SPECIFICATIONS

**Connector Durability:** 500 cycles minimum  
**Contact Torque:** 4.0 inch-ounces minimum  
**Coupling Nut Mating Torque:** 8-10 lbs

### ELECTRICAL SPECIFICATIONS

**Nominal Impedance:** 50 Ω

**Frequency:** DC-34 GHz

**VSWR:** 1.05 + .006 f (f=GHz) Max. DC-34 GHz

**Contact Resistance:** Center Contact = 3.0 milliohms,  
Outer Contact = 2.0 milliohms

### ENVIRONMENTAL SPECIFICATIONS

**Temperature Rating:** -55°C to +105°C



FIG. 1  
P2RF35F-35F-00000



FIG. 2  
P2RF35M-35F-00000



FIG. 3  
P2RF35M-35M-00000,



FIG. 4  
P2RF35M-35M-G0000

PHOTOS FOR REFERENCE ONLY, shown at 150% actual size.

PART #	FIG	DESCRIPTION	NOTES	PLATING		
				BDY	P/C	DIE
P2RF35F-35F-00000	1	Adapter	3.5mm Female to 3.5mm Female	SS	G	R
P2RF35M-35F-00000	2	Adapter	3.5mm Male to 3.5mm Female	SS	G	R
P2RF35M-35M-00000	3	Adapter	3.5mm Male to 3.5mm Male	SS	G	R
P2RF35M-35M-G0000	4	Adapter	3.5mm Male to 3.5mm Male	G	G	R